

STURT STREET NEWS

July 2019

International Student Sponsorship Program

Page 5

Bible Reading
Plan

Pages 6-7

Facility Upgrade
Project

Pages 34-35

International
Student
Sponsorship
Program

Pages 36-37

Hughes Family
Update

GENERAL INFORMATION



5 Bible Reading Plan



34-35 Student Sponsorship Program



6-7 Facility Upgrade Project



36-37 Hughes Family Update

CONTENTS

General Information 2-10

Welcome	3
About Us	3
Upcoming Events	4
Bible Reading Plan	5
Facility Upgrade Project	6-7

Connect Groups 8-10

Information	9
Northfield Connect Group	10

Church Ministries 11-15

Playgroup	12
Crèche	12
Grow	13
Elevate	13
Empower	14
Engage	14

Seniors	15
Equip	15

Adelaide City Care 16-17

About Us	17
Programs	17

Adelaide Christian Schools 18-19

About Us	19
Our Schools	19

Missions 20-37

Monthly Missions Giving	21
Christian Education	22-23
Helping the Needy	24-25
Missionary Service	26-27
Ministry Training	28-29
Tax Deductible Projects	30-31
Rebuilding Batticaloa	32-33
Student Sponsorship	34-35
Hughes Family Update	36-37

WELCOME

Welcome to our July edition of Sturt Street News!

This year is flying by! We are now entering into the second half of the year and our church events show no sign of slowing down anytime soon.

I would like to extend a big thank you to everyone who assisted us with our New Arrivals Dinner and Food and Fun Day last month. Your efforts are very much appreciated. I love being in a church full of willing and helpful people!

Enjoy reading through this Sturt Street News.

Bless you all,
Pr Mike Groom

Our Contact Details

Office: 33 Sturt Street, Adelaide SA 5000
Tuesday-Friday, 9am-5pm

Email: office@adelaidechristiancentre.com.au

Phone: (08) 8212 2322

Web: www.adelaidechristiancentre.com.au

Our Team

Lead Pastor: Pr Mike Groom

Associate Pastor: Pr Gregg Manego

Children: Sturt Street Kids Team

Youth: Empower Team

Young Adults: Engage Team

Seniors: Peter Chigwidden

Finance: Kelly Groom

Administrator: Marita Mabulac

Adelaide City Care: Pr Gregg Manego

Elders Team: Pr Mike Groom, Pr Gregg Manego, Pr Neil Milne, Hew Barnard Brown, Lin Andrews and Ian Wood

ABOUT US

We are a city-based Pentecostal church. We gather every Sunday, as people of all ages from all walks of life, to celebrate God and to experience a powerful message, teaching truths from the Bible. Our gatherings are relaxed with friendly people, modern music and media presentations. You are more than welcome to join us any Sunday at our 10am gathering.

Vision

To be a Christ-centred community of believers who obey the Great Commission

Mission

Empowering people for life change

Strategy

Engage people with Jesus
Establish people into faith
Equip people for service
Empower people to serve

Generous Giving

Tithes and Offerings

Adelaide Christian Centre
BSB: 065005 Acc: 0090 3471

Missions Offerings

Adelaide Christian Centre
BSB: 065005 Acc: 0090 3471

Adelaide City Care Donations

Tax Deductible Donations
BSB: 065005 Acc: 1009 3025



GENERAL INFORMATION



UPCOMING EVENTS

1 Missions Sunday Sunday 7th July

On each of our Missions Sundays we take up a special missions offering for all of the fields we support as a church. For more information on who and what we support please go to page 21 of this Sturt Street News.

2 Vision Sunday Sunday 28th July

During our Vision Sunday service Pr Mike will share an overview of where the church is at and what some of the plans are for the future. Many things have happened in the life of our church so be sure to come along.

3 Annual General Meeting Sunday 28th July

All of our church members are encouraged to attend our Annual General Meeting for 2019. This meeting provides further information on the running of our church and includes reporting on various areas.

4 Prayer and Praise Night Thursday 8th August

At the start of next month we have our Prayer and Praise Night at 7:30pm at church. This is a churchwide event and all connect groups are encouraged to attend. Join with us as we come together in prayer and worship.

GENERAL INFORMATION

BIBLE READING

July 1, 2019

2 Samuel 1, 2 Samuel 2, 2 Samuel 3

July 2, 2019

2 Samuel 4, 2 Samuel 5, 2 Samuel 6

July 3, 2019

2 Samuel 7, 2 Samuel 8, 2 Samuel 9

July 4, 2019

2 Samuel 10, Psalms 20, Psalms 21

July 5, 2019

2 Samuel 11, 2 Samuel 12, Psalms 51

July 6, 2019

2 Samuel 13, 2 Samuel 14, 2 Samuel 15

July 7, 2019

2 Samuel 16, 2 Samuel 17, Psalms 55

July 8, 2019

Psalms 62, Psalms 70, Psalms 71, Psalms 43

July 9, 2019

2 Samuel 18, 2 Samuel 19, 2 Samuel 20

July 10, 2019

2 Samuel 21, 2 Samuel 22, Psalms 18

July 11, 2019

2 Samuel 23, 2 Samuel 24, 1 Kings 1

July 12, 2019

1 Kings 2, 1 Kings 3, 1 Kings 4

July 13, 2019

1 Kings 5, 1 Kings 6, 1 Kings 7

July 14, 2019

1 Kings 8, 1 Kings 9, 1 Kings 10

July 15, 2019

1 Kings 11, 1 Kings 12, 1 Kings 13

July 16, 2019

1 Kings 14, 1 Kings 15, 1 Kings 16

July 17, 2019

1 Kings 17, 1 Kings 18, 1 Kings 19

July 18, 2019

1 Kings 20, 1 Kings 21, 1 Kings 22

July 19, 2019

2 Kings 1, 2 Kings 2, 2 Kings 3

July 20, 2019

2 Kings 4, 2 Kings 5, 2 Kings 6

July 21, 2019

2 Kings 7, 2 Kings 8, 2 Kings 9

July 22, 2019

2 Kings 10, 2 Kings 11, 2 Kings 12

July 23, 2019

2 Kings 13, 2 Kings 14, 2 Kings 15

July 24, 2019

2 Kings 16, 2 Kings 17, 2 Kings 18

July 25, 2019

2 Kings 19, Psalms 44, Psalms 75, Psalms 76

July 26, 2019

2 Kings 20, 2 Kings 21, 2 Kings 22

July 27, 2019

2 Kings 23, 2 Kings 24, 2 Kings 25

July 28, 2019

Mark 1, Mark 2, Mark 3, Mark 4

July 29, 2019

Mark 5, Mark 6, Mark 7, Mark 8

July 30, 2019

Mark 9, Mark 10, Mark 11, Mark 12

July 31, 2019

Mark 13, Mark 14, Mark 15, Mark 16

GENERAL INFORMATION

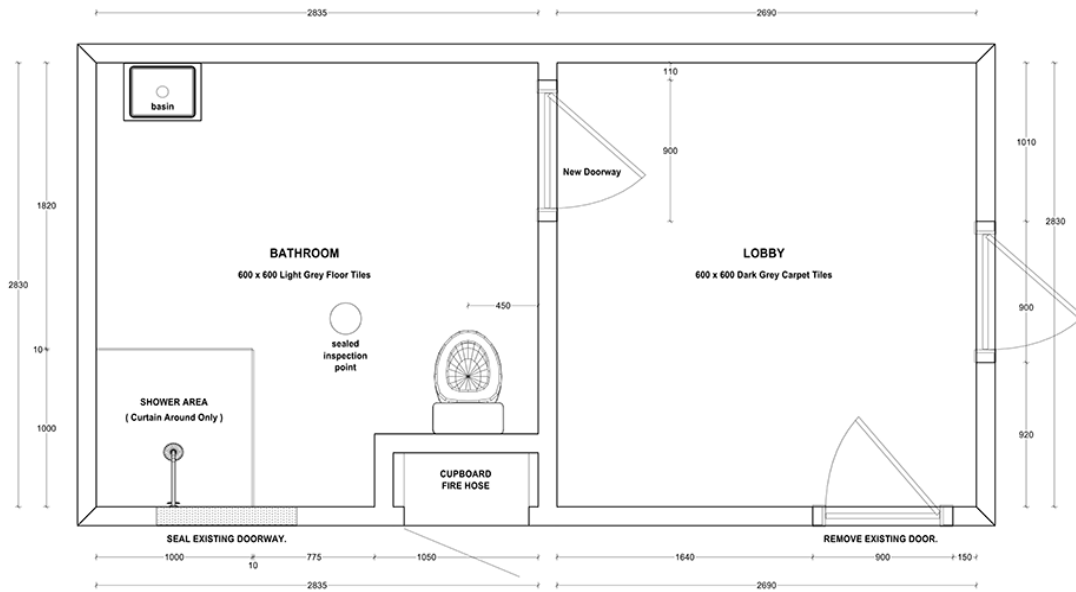

FACILITY UPGRADE PROJECT

1st July 2019 - 30th June 2020

Over the last few years we have focused on upgrading various parts of our church facility.

We have moved our church offices to 33 Sturt Street. We have upgraded the upstairs area to create space for our children and youth. We have upgraded the crèche and installed an indoor playground. We have replaced all the carpet in the foyer and other areas downstairs, as well as painted the walls.

Our Facility Upgrade Project carries on with our desire to improve our church facility. Please read ahead for more information.

ABOUT THE PROJECT

The first phase of our Facility Upgrade Project is complete. This includes the refurbishments that were done to the auditorium (painting and carpet) and the signs that have been installed inside and outside the building.

We are nearing completion of phase two of the project which consists of constructing the facilities listed below.

1. Accessible toilet and shower
2. First aid room
3. Lobby entrance into both areas

We are excited about these developments and we believe they will be of great benefit to our church family and all guests who experience our facility.

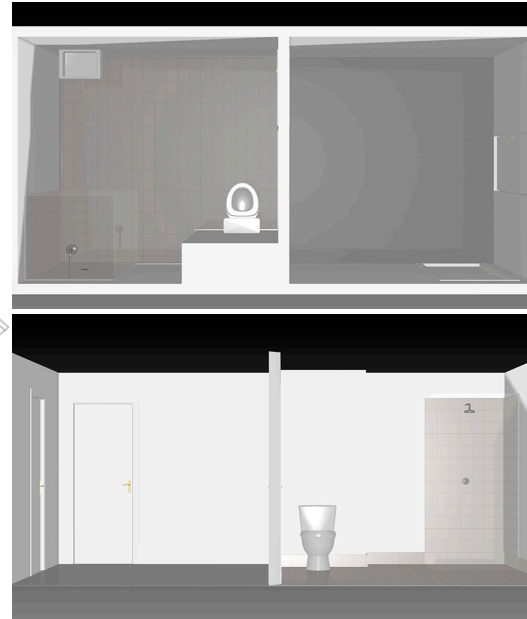

PROJECT COSTS

Please see the figures below that outline the individual costs of phases one and two of this project, along with the total cost of the overall project.

Phase One

Auditorium refurbishment and installation of signs

Total Required - \$37,400.00

Phase Two

Accessible toilet and shower, lobby, first aid room

Total Required - \$28,000.00

TOTAL PROJECT COSTS

\$65,400.00

MAKING A PLEDGE

How can you contribute?

- One off donation
- Monthly contribution

Tax Deductible Donations

This is a tax deductible project. All tax deductible receipts for donations over \$2 will be issued by Adelaide City Care which is a Deductible Gift Recipient (DGR).

Account Name: Adelaide City Care
BSB: 065005

Account Number: 1009 3025

Reference: Upgrade Project

Thank you very much for your support of our project. Every donation, no matter how big or small, is greatly appreciated.



Connect Groups

CONNECT GROUPS

INFORMATION

Adelaide Christian Centre loves connect groups! We have a great number of people throughout the life of our church attending a small group on a regular basis.

We believe that life change happens best in small groups, through accountability, a sense of belonging and knowing that others care.

Hebrews 10:24-25 says: *Let us consider how we may spur one another on to love and good deeds. Let us not give up meeting together. Let us encourage one another.*

Day Time Groups

Group: Ladies (Fortnightly)
Location: Gilles Plains
Leader: Diane Taylor
Phone: 0422 435 355

Monthly Groups

Group: Seniors (3rd Thurs of month)
Location: Adelaide Christian Centre
Leader: Peter Chigwidden
Phone: 0407 398 988

Youth and Young Adults

Group: Empower Youth (12-17)
Location: Adelaide Christian Centre
When: Tuesday nights
Time: 7-8:30pm

Group: Engage Young Adults (18-25)
Location: Adelaide Christian Centre
When: Tuesday nights
Time: 7-8:30pm

Evening Groups

Location: Hallet Cove
Leader: Don Datu
Phone: 0451 151 509

Location: Ingle Farm
Leader: Angelito and Marycel Gatdula
Phone: 0402 644 117

Location: Marion
Leader: Emil Sagun
Phone: 0438 277 990

Location: Mt Barker (Fortnightly)
Leader: Nohn Cubio
Phone: 0439 921 890

Location: Seacombe Gardens
Leader: Rommel Verain
Phone: 0435 747 343

Location: Rosewater
Leader: Liway Cotton
Phone: 0447 616 536

Location: Newton (Fortnightly)
Leader: Brian Mortimer
Phone: 0434 360 257

Location: Underdale
Leader: Pr Mike Groom
Phone: 0400 560 501

Location: Northfield
Leader: Orville and Jessica Piol
Phone: 0430 618 489

Group: Enable
Location: Location varies
Leader: Vinnie and Margaux Miranda
Phone: 0430 333 370

CONNECT GROUPS



NORTHFIELD CONNECT GROUP

As believers, we always welcome any activity that helps people grow in Christ. This is a belief that everyone at the Northfield Connect Group shares.

Our group is composed of a variety of individuals coming from different age groups. This gives us a wide range of experience from which to draw upon during our talks.

Our fortnightly meetings are not simply social gatherings that focus on fellowship and refreshments, although the sharing of yummy food and interesting stories is always welcome.

Our primary reason for meeting together is to connect with others in a personal, life

transforming, and spiritually meaningful way.

In our connect group meetings we have praise and worship, prayer, discussions and fellowship around God's word. We encourage everyone to actively participate in each other's life through the sharing of personal insights and testimonies.

Many of our connect group members are in the medical field and have children. This creates a situation in which conflicts in schedule, family commitments, sickness, school programs and work activities prohibit almost everyone from being present at every one of our connect group meetings.

To combat this issue, members regularly communicate with each other through phone calls, group chats and individual home visits.

Occasionally we also gather together for some recreation and fun activities where we gradually become connected emotionally and spiritually and thus form lasting friendships.

It is also great to see that the young children in our connect group have also formed a bond of their own just like their parents.

We are a warm and friendly bunch of people and would very much welcome joint meetings with other connect groups.

Although we are still a relatively young group, everyone is positive that the Northfield Connect Group will continue to thrive as we help each other grow in our walk with the Lord and with each other.

Church Ministries



PLAYGROUP

0-6 Years

Giggle Patch Playgroup runs every Wednesday morning from 10am-12pm at 27 Sturt Street, Adelaide.

Our playgroup only runs during school terms, not during the holidays. An indoor playground and a variety of other activities are available for children under 6 years of age.

A number of new families have joined our playgroup this year which is great!

Parents are encouraged to come along to enjoy some time together where they can create new friendships and continue to develop existing ones. The children are able to play together and have some fun.

Tea and coffee is provided for parents. Everyone is requested to please bring a gold coin donation.

If you would like any further information on Giggle Patch Playgroup or if you would like to volunteer, contact Raquel Edwards or the church office via phone or email. Contact details for the church office can be found on page 3.



CRÈCHE

0-3 Years

Our crèche is open every Sunday morning during the service for all those aged 0-3 years. Parents are welcome to sign their kids in anytime from 9:45am and are asked to sign them out no later than 11:45am or whenever the service finishes.

Our crèche consists of an open space where children have access to a variety of fun toys, craft materials, books and more. Children also have the opportunity to enjoy our indoor playground!

Attached to our crèche is a feeding room for breast feeding mothers and babies. An audio link and a window looking out into the auditorium allows mothers to see and hear what is going on in the church service whilst they are using the room.

We ask that all parents please assist us in keeping our crèche area clean and safe for young children. This space is for children three years and younger only. Whenever young children are in the crèche they need to be supervised. Please assist us in keeping our crèche tidy for those who use it by cleaning up after your children.



GROW

3-6 Years

It is July! We have passed the middle of the year which mean it's time for more school holidays!

These school holidays we are doing things a bit different in Grow. We will be trialing a school holiday program.

Our school holiday program will consist of fun and games! We will incorporate some movies and maybe some special snacks.

My challenge for everyone in July is a simple one. I encourage you to do something amazing for someone with no expectation of return!

Some suggestions include mowing a neighbours lawn, making a batch of biscuits and sharing them with a friend, helping in your local community, cleaning the church or helping a friend who needs a hand.

Thank you for your ongoing prayers and support.

God Bless,
Cassie Beattie



ELEVATE

7-11 Years

July sees the end of term two and the beginning of term three. Elevate will not take a break over the school holiday period. Instead, we will be running fun activities each Sunday morning during the holidays.

In term three our major topics will be FORGIVENESS and ENDURANCE.

The main lessons we will learn for FORGIVENESS are: 1) Jesus has the power to forgive; 2) We all need to be forgiven; 3) Forgive because you've been forgiven; 4) Ask for forgiveness; and 5) Forgive everyone like Jesus did.

The main lessons we will learn for ENDURANCE are: 1) God will help you stand strong; 2) Stand strong because God is with you; 3) Stand strong because you know the truth; and 4) Stand strong because God's team wins in the end.

We encourage all of our Elevate parents to join our Facebook group. This is where we will post all of our need to know information and latest updates: www.facebook.com/groups/elevateacc

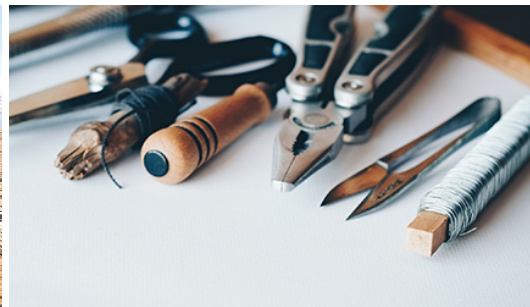

EMPOWER

12-17 Years

Empower Youth has enjoyed a very fun and successful term two. We have now reached July which means Empower will be taking a two week break over the school holiday period.

Please keep in mind that our final connect group for term two will be held on Tuesday 2nd July and our final youth event for term two will be held on Friday 4th July.

We trust all of our youth will have an enjoyable and safe break from school.

We are looking forward to kicking off term three with connect group on Tuesday 23rd July. Our events will reconvene on Friday 26th July.

If anyone has any ideas for our youth events for terms three and four please let one of our youth leaders know. We would love to hear from our youth!

We encourage all youth members to join our Facebook group. This is where we post all our event details and important information for you: www.facebook.com/groups/cityempower

ENGAGE

18-25 Years

Engage has been running extremely well this year. It has been awesome seeing some of our members taking initiative and organising events and hangouts for the wider group.

It has also been awesome seeing some new faces and getting to know new people. We have noticed that there are a lot of people coming into the church that are within our Engage age group. This means that Engage will keep growing and growing!

All Engage members are welcome to join us for our final Tuesday night connect group for term two on Tuesday 2nd July. Connect group will begin again for term three on Tuesday 23rd July.

If you are between 18 and 25 years of age please feel free to join us!

We have a Facebook group where we post all of our updated event details and need-to-know information. You are more than welcome to join our group: www.facebook.com/groups/engagesturtstreet

SENIORS

50+ Years

Welcome to the seniors ministry of Adelaide Christian Centre!

Our seniors ministry aims to provide the senior members of our church with a challenging, inspiring and encouraging support network.

This is a place where they can gather together to support one another and share life together.

Thank you to all those who gather regularly to build relationships, give encouragement and do life together.

July Event

Our seniors event for July will be held on Thursday 18th July.

All seniors are invited to meet at church for a 10am start.

Please bring your own money for lunch. Lunch will be eaten at a nearby location.

If you require any further information please contact Peter Chigwidden.

EQUIP

Equip Training College (ETC)

We are intentional about equipping effective followers of Christ and well-trained leaders who are able to lead others in life and ministry.

ETC has been designed specifically with the development of congregational members of Adelaide Christian Centre (ACC) in mind. Its unique curriculum and desired outcomes are tailor made to fulfil the Biblical mandate as clearly stated in the book of Ephesians (4:11-12).

Enrolments Information

If you would like a copy of the ETC Course Outline please ask the church office or ask at the info desk in the church foyer.

If you are interested in enrolling or expressing interest in one of our courses you can do so at the info desk or by contacting the church office.

Candidates will be invited to enrol into either the 18-month Certificate in Christian Ministry and Theology course or the three year Diploma in Christian Ministry and Leadership course.



A delaide City Care

ADELAIDE CITY CARE

ABOUT US

Adelaide City Care is a not-for-profit organisation. The mission of Adelaide City Care is: *Empowering people for life change.*

As an arm of Adelaide Christian Centre, we are committed to supporting those who are new arrivals to South Australia. In 2006 this group was recognised as a potentially disadvantaged group. Our initiatives assist new arrivals to combat social isolation, foster social inclusion and increase their employability.

Through our programs we aim to help new migrants ease into their settlement in Australia, assimilate into the broader community, and improve their family lifestyle. Information is provided about assistance that is available including social welfare services, employment, housing, accommodation, banking and finance.

Give to Adelaide City Care

Our primary means of resources come from those who generously contribute to this part of our work. If you would like to help us please donate online by EFT:

Tax Deductible Donations

Adelaide City Care

BSB: 065005

Acc: 1009 3025

Our Contact Details

Office: 33 Sturt Street, Adelaide SA 5000
Tuesday-Friday, 9am-5pm

Email: info@adelaidecitycare.com.au

Phone: (08) 8212 2322

Web: www.adelaidecitycare.com.au

PROGRAMS

Meet and Greet Service

New migrants are met at Adelaide Airport and transported to their accommodation. We help them settle into their accommodation and provide information about essential tasks that need to be done on arrival.

New Arrivals Dinner

A special dinner which is run four times a year to welcome new migrants to South Australia. Qualified consultants are invited to speak on housing and accommodation, employment, and finance and banking.

Food and Fun Day

A fun-filled day that runs three times a year. The event includes a self-serve meal, social interaction through table tennis, bouncy castles and other activities. This is a great way for new migrants to build relationships with members of the community.

Speak, Hear, Speak

Speak, Hear, Speak is an English class that runs every Tuesday evening during the school term. These classes provide free conversational English lessons to new arrivals and others who consider English as their second language.

Practical Assistance

Adelaide City Care provides additional practical assistance to the disadvantaged members of the community including new arrivals to South Australia regardless of their age, sex, ethnic background, religion, political beliefs and marital status.

Adelaide Christian Schools

ADELAIDE CHRISTIAN SCHOOLS



ABOUT US

A significant part of the mandate of our church is Christian Education. Leo Harris had a vision for Christian Education and plans were developed in 1976 and 1977 for a Christian School. Sunrise Christian School was founded in 1978 in Fullarton. A few years later Temple Christian College was founded as a sister organisation for high school students.

Adelaide Christian Schools (ACS) is an organisation that aims to oversee and support its schools ranging from Reception to Year 12 in co-educational settings and other training establishments. ACS is called to educate and train children in all aspects of life in such a way that God is seen to be the centre of everything - to be an extension of the Christian home, fulfilling the God-given mandate for parents to bring up their children in His ways.

The schools are governed by a Board with membership comprising individuals with vast experience and expertise from a variety of industry sectors. The Board works closely with Committees and Advisory Groups that have been established in each school community to engage with local leadership at a grass roots level, providing an opportunity for local input and expression.

OUR SCHOOLS

ACS governs and supports 11 schools. These schools comprise of approximately 2300 students and in excess of 250 staff. Each school offers its own distinctive qualities that focuses on the role of the family in education, character development and excellence in academics.

Australian Schools

Sunrise Christian School

- Fullarton, SA	R - 7	Est. 1978
- Paradise, SA	R - 7	Est. 1989
- Morphett Vale, SA	ELC - 7	Est. 1994
- Marion, SA	R - 12	Est. 2002
- Naracoorte, SA	R - 7	Est. 2005
- Whyalla, SA	ELC - 7	Est. 2009

Temple Christian College

- Mile End, SA	7 - 12	Est. 1983
- Paralowie, SA	7 - 12	Est. 2001

Discovery Christian College

- Agnes Water, QLD	3 - 10	Est. 2015
--------------------	--------	-----------

International Schools

Sunrise Bethel Christian School

- Port Moresby, Papua New Guinea

Faith Christian School





- Walhalla, South Carolina, USA



MISSIONS

MONTHLY MISSIONS GIVING



Christian Education

	Fiji Islands	<i>Bethel Crusade Preschools</i>	\$300.00
	Papua New Guinea	<i>Bethel Sunrise School</i>	\$300.00
	U.S.A.	<i>Faith Christian School</i>	\$500.00
	Sri Lanka	<i>Door of Hope Preschool</i>	\$400.00



Helping the Needy

	Sri Lanka	<i>Bethel Children's Homes & Farm</i>	\$400.00
	Philippines	<i>Children's Feeding Programs</i>	\$100.00

Missionary Service

	Papua New Guinea	<i>Rachelle Hardy</i>	\$200.00
	U.S.A.	<i>Warwick and Omega Hughes</i>	\$600.00
	World	<i>Pastor Barry Silverback</i>	\$1,000.00

Ministry Training

	Papua New Guinea	<i>Bethel Bible College</i>	\$300.00
	Papua New Guinea	<i>Student Sponsorship Program</i>	\$500.00
	India	<i>Missions Training School</i>	\$500.00
	India	<i>Evangelos Training Institute</i>	\$250.00

Other

	Sri Lanka	<i>Colombo Building Project</i>	\$100.00
	Australia	<i>Indigenous Outreach</i>	\$250.00

COMBINED TOTAL

\$5,700.00

JULY 2019

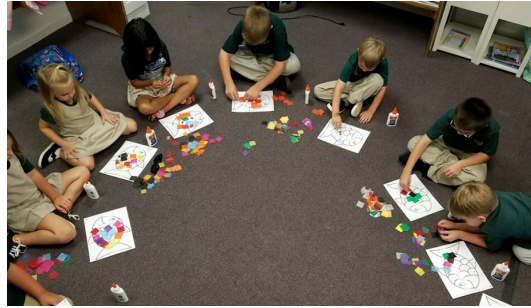

Bethel Crusade Preschools

Fiji: \$300 per month

Tax Deductible Project Code: J352N

Bethel Crusade Preschools began in Suva in 1994 with nine children. Since then approximately 3,000 children have graduated from the preschools. Bethel Crusade Preschools have expanded to reach a total of eight preschools located throughout Fiji in Sigatoka, Suva, Lakena, Savusavu, Nacavanadi, Labasa, Daku and on Koro Island.

Prayer Points:

- Pray for all the children as they continue their preschool education
- Pray for all of our preschool teachers
- Pray for positive outcomes for changes in the government involving education

Sunrise Bethel Christian School

PNG: \$300 per month

Tax Deductible Project Code: J573N

Based in Port Moresby, Sunrise Bethel Christian School is a non-denominational, co-educational school. It is part of Adelaide Christian Schools, a ministry of Adelaide Christian Centre. The school is located on the grounds of Bethel Tabernacle of Praise Church and currently has approximately 250 students. This is an excellent ministry that we are involved in!

Prayer Points:

- Pray for any challenges facing the school in 2019
- Pray for all of the staff and teachers
- Pray for all of the students as they continue on in the 2019 school year

Faith Christian School

U.S.A: \$500 per month

Faith Christian School is located in Walhalla, South Carolina. It is an international member school of Adelaide Christian Schools which is a ministry of Adelaide Christian Centre. It is associated with Faith Christian Center, our national CRC centre in the United States. The school offers a Christ-centered innovative learning experience, where character development and the role of the parent is paramount.

Prayer Points:

- Pray for any challenges facing the school in 2019
- Pray for all of the staff and teachers
- Pray for all of the students as they continue on in the 2019 school year

Door of Hope Preschool

Sri Lanka: \$400 per month

Door of Hope Preschool has been running for a few years now and is located in Vavuniya in the north of Sri Lanka. It is predominantly made up of Tamil speaking children. We currently have one employed teacher and a lady who volunteers her time to come and assist with teaching the children. Our support for Door of Hope Preschool is allocated to the running of the preschool.

Prayer Points:

- Pray for any challenges faced at the hand of the local government
- Pray for our staff and teachers
- Pray for all the children as they continue their preschool education



Bethel Children's Homes

Sri Lanka: \$400 per month

Tax Deductible Project Code: J982N

Bethel Children's Homes have been in operation since 1998 when the first home opened with 11 girls. Since then two new homes have been built to house more girls on the same property. A property was also purchased to build a new home for boys. All of the children in the homes have been affected in some way by the war and civil unrest in Sri Lanka. This has resulted in them being displaced, physiologically affected and discriminated against.

The homes have government permission to care for up to 40 children. They maintain a family-like environment by ensuring a high level of individual care. The homes ensure all children are sent to primary and secondary schools within the community,

assures all medical and healthcare needs are met, provides all subsistence needs (i.e. food, clothing, shelter, water, sanitation, recreation etc.), and commits to continually support their overall physical, emotional, mental and intellectual development.

Our church provides financial and management support for the children and staff within the homes. As a church we sponsor four children - Angel, Sharon, Jonathan and George.

Prayer Points:

- Pray that all new children who come into the home will settle in
- Pray for our dedicated staff who take care of the children day-to-day
- Pray for safety following the Easter Sunday bombings in Sri Lanka

Children's Feeding Programs

Philippines: \$100 per month

Thousands of children have been ministered to throughout the Philippines by our feeding programs. Our children's feeding programs use strict attendance and monitoring records and are run for children in three age groups - 3 to 6 year olds (Level 1), 7 to 10 year olds (Level 2) and 11 to 14 year olds (Level 3).

Multiple activities are included within the feeding programs - feeding, Bible teaching, Gospel preaching, prayers for the children and their families, prayers for the communities, world missions orientation, games, memory verses, praise and worship, and assignments on the Bible. These programs may also go further to include children camps, family visits and Christmas gift giving.

CRC children's feeding programs differ from other feeding programs in the Philippines. They do not simply seek to provide food to children to fill their stomachs on a short term basis. They aim to provide education on nutrition and to provide nutritious meals so the health of children and their families may improve long term.

Prayer Points:

- Pray for our workers in the Philippines who faithfully serve in this ministry
- Pray that the feeding programs will open a way to reach whole communities for Christ
- Pray for all the children involved that they will respond to the Gospel message



Rachelle Hardy

PNG: \$200 per month

Rachelle Hardy is a long-serving CRC missionary. She is primarily based in Port Moresby and oversees the World Missions Faith Training School. Rachelle travels regularly to India to provide leadership to the World Missions Faith Training School located there. She is an extremely faithful and hard working woman and we are very pleased to be supporting her as a church.

Prayer Points:

- Pray that she will stay safe as she continues on in India
- Pray for God's ongoing guidance and protection over her life
- Pray for fruitful ministry in all of her future endeavours



Pr Barry Silverback

World: \$1,000 per month

Pr Barry Silverback is the CRC International Missions Director and is one of the longest serving members of Adelaide Christian Centre. He travels extensively to many nations teaching, preaching and mentoring many. He truly is a 'father in the faith' to hundreds of people around the globe.

Prayer Points:

- Pray for God's hand of protection as he continues to travel
- Pray for God's guidance and wisdom in all of the decisions Pr Barry is involved in making for various nations and ministries
- Pray for fruitful ministry in all that he sets out to do



Warwick and Omega Hughes

USA: \$600 per month

Pr Warwick is originally from New Zealand and was a missionary in Papua New Guinea (PNG) for many years. In PNG he was heavily involved in training students through the World Missions Faith Training School. He met his wife Omega in PNG and together they have two children - Jethro and Warwick Jr.

After a long process acquiring visas, in August 2018 Pr Warwick and his family relocated to Walhalla, South Carolina in the United States. Pr Warwick is currently serving as our senior pastor at Faith Christian Center. The family has been well received by the local congregation and Pr Warwick is doing a fantastic job as senior pastor.

The Adelaide Christian Centre eldership,



primarily through Pr Mike, provide guidance and support where necessary to Pr Warwick and the local leadership at Faith Center Church. Pr Mike visits Walhalla twice a year.

A recent report from Pr Warwick can be found on pages 36-37 of this Sturt Street News.

Prayer Points:

- Pray for the family as they continue their ministry in the United States
- Pray for Faith Center Church and the church's congregation as a whole
- Pray for Pr Warwick's fruitful ministry as he continues in his role as senior pastor
- Pray for newcomers to Faith Center Church to feel at home and to consider staying long-term



Bethel Bible College

PNG: \$300 per month

Bethel Bible College is a two year live-in program. The first year follows the World Missions Faith Training School (WMFTS) curriculum. This College provides a unique opportunity for specialised study and preparation for ministry. Students are from many countries. The environment of cross-cultural relationships provides an ideal setting for an active discipleship school.

Prayer Points:

- Pray for all the staff involved in the school
- Pray for all students that they do well in their studies
- Pray that all new students who began in 2019 will settle in and thrive

Student Sponsorship

PNG: \$500 per month

Dipen is a graduate of WMFTS in India. He is currently serving at Bethel Centre PNG. Ilisoni and his family are from Fiji. His wife Viema runs the Preschool Teacher Training at Bethel Centre and he is enrolled in Bethel Bible College.

Prayer Points:

- Pray for God's guidance and direction for both Dipen and Ilisoni
- Pray for God's protection in Dipen and Ilisoni's ministry endeavours
- Pray for effective and fruitful ministry in all Dipen and Ilisoni are involved in
- Pray for Ilisoni, Viema and their two children as they settle into Bethel Centre

Missions Training School

India: \$500 per month

WMFTS exposes men and women to the missionary mandate, informing, training, preparing and inspiring them to become missionaries around the world. The school is located in West Bengal in the North East of India and is looked after by a group of faithful staff.

Prayer Points:

- Pray for all the staff involved in the school
- Pray for all students that they do well in their studies and stay strong in their commitment to completing the program
- Pray for any challenges that the school faces from the government

Evangelos Training Institute

India: \$250 per month

Purnima is a graduate of WMFTS India. She has served in Papua New Guinea and Fiji. She is now back in India. We have supported Purnima for a number of years and we now support her through her ministry at the Evangelos Training Institute. Her team are doing an excellent job running the school and we are happy to support them!

Prayer Points:

- Pray for all the staff involved in the school that they will find strength to continue serving
- Pray for all students that they do well in their studies
- Pray for staff to remain in good health as we have had multiple sicknesses lately



TAX DEDUCTIBLE DEVELOPMENT PROJECTS

Two of our CRC children's ministries have tax deductible projects running from 2018-2020. This is an exciting development and we are looking forward to seeing all that will be achieved within our preschools in Fiji and children's homes in Sri Lanka throughout these projects.

A general overview of each project is included within the following columns. We have also included information for those of you who are looking to give tax deductible donations to the projects.

We appreciate all of your generous and ongoing support for our preschools and children's homes.

Fiji Preschools Development Project

Tax Deductible Project Code: J352N

From 2018-2020 we are working on a project to improve Bethel Crusade Preschools for students, teachers and the local communities where our preschools are located.

The major objective of the new project is: *To have eight fully functioning preschools complete with facilities that meet government and OHS standards, trained and certified teachers, and sewing courses to empower mothers and other women in the preschool communities.*

If you would like any further information on the project please pick up a project booklet from the info desk or the table at the back of the auditorium.

Sri Lanka Displaced Children Development Project

Tax Deductible Project Code: J982N

We launched a three year project for our children's homes in January 2018 for ongoing development and sustainability.

The major objective for this project is: *To support and empower displaced children and young people through quality education (primary, secondary and tertiary), improved healthcare, adequate subsistence (food, clothing, accommodation, water, sanitation and recreation), a safe family-like living environment, and ongoing developmental support (physical, emotional, mental and intellectual).*

To discover more about the project please pick up a project booklet from the info desk or the table at the back of the auditorium.

Step 1: Direct Bank Deposit (online)

Direct Deposit tax deductible donations can be made using the following details.

Account Name: Global Development Group
BSB: 064118

Account Number: 10200094

Reference: e.g. J. Smith J352N/J982N

Please make sure you include your initials (e.g. J. Smith), followed by the code for the project you wish to donate to (**J352N** for Fiji Preschools or **J982N** for Sri Lanka Children's Homes) in the reference section so GDG can trace your deposit.

Step 2: Email GDG your donation details

Email info@globaldevelopment.org.au with the following details.

- a) Your name and address
- b) Amount and date of donation
- c) Project code - **J352N** or **J982N**

GDG will send you a receipt for your tax deductible donation. If you would like to contribute to the project on a regular basis you will need to set this up with your bank and then let GDG know in your initial email.

For more information or to donate online:

- Fiji Preschools
www.gdg.org.au/InfoJ352N
- Sri Lanka Children's Homes
www.gdg.org.au/InfoJ982N

Bethel Crusade Preschools and Door of Hope International are partners for J352N and J982N with Global Development Group (ABN 57 102 400 993), an Australian NGO approved by the Minister of Foreign Affairs.



SRI LANKA RELIEF PROJECT: REBUILDING BATTICALOA

On Easter Sunday 2019 explosions went off in multiple churches and hotels across Sri Lanka. Five attacks were carried out around the capital city of Colombo. One bombing occurred in Batticaloa in the Eastern Province of Sri Lanka.

More than 250 people lost their lives as a result of these Easter Sunday attacks and hundreds more were injured. Many people have been left with lifelong disabilities and injuries.

The nation remains in an uncertain and

fragile state as reports of potential additional explosions continue to surface.

One of the churches that was targeted during the bombings was Zion Church in Batticaloa. The church building, accommodation block, pastor's house, lecture rooms and the church bookshop were all badly damaged by the blast and are in desperate need of repair.

As of Wednesday the 1st of May, it is confirmed that 30 people in the church have lost their lives and a number of people remain in hospital, some are still in a critical condition. Numerous people have been left with lifelong injuries, such as blindness and loss of limbs.

Many of the deaths from this attack were children who had just finished Sunday School and were waiting at the entrance

of the church for their parents so they could head into the Easter Sunday Service together.

Working in partnership with Global Development Group (GDG), the Sri Lanka Relief Project: Rebuilding Batticaloa, is supporting the rebuilding and repair of the church facilities that were damaged.

People from Australia, New Zealand and the United States of America who give towards the project are eligible to receive tax deductible benefits. Anybody who does not require tax deductibility can still give through the project.

A fundraising page has been set up for the project through Raisely. A goal of \$50,000 has been set for the project. Please refer to the details in the following column if you are looking to make a donation.

Online Donations

We encourage all donations to go through the Raisely fundraising webpage. Donations made through Raisely are sent to GDG.

Through the Raisely fundraising platform you can submit a one-off donation or you can commit to a monthly contribution.

Please follow the link below to give towards the rebuilding of Zion Church in Batticaloa.

www.gdg.org.au/DonateJ1043N

If you are interested in making a donation but are unable to donate online please speak to Marita at the info desk or contact the church office (contact information can be found on page 3).



Sri Lanka Relief Project: Rebuilding Batticaloa is a partner for Project J1043N with Global Development Group (GDG; ABN 57 102 400 993). GDG is a charitable Non Government Organisation [NGO] carrying out humanitarian projects with approved partners and providing aid to relieve poverty.

All gifts over \$2 are representative of project activities and are received as tax deductible donations in Australia with a preference for project J1043N. All donations are received subject to GDG's donation and privacy policy (www.gdg.org.au/policy). If excess funds are received they may be applied to other approved project activities.



INTERNATIONAL STUDENT SPONSORSHIP PROGRAM

MESSAGE FROM THE CRC'S INTERNATIONAL MISSIONS DIRECTOR

Around 1986 Bethel Christian Centre in Port Moresby, PNG decided to try and do something for people from developing countries who did not have the opportunity or access to study or training in Christian ministry and service for the Lord. Bethel began ISSP as part of Bethel World Missions in response to this need.

ISSP allows us to recruit people from nations where the Bethel World Missions

arm has pioneered CRC ministries. We do not focus on people just from CRC churches, but also those from non-CRC ministries that we either partner with or have some relationship with.

In practical terms, this program involves us fully sponsoring students for their medicals, passports, visas, international and domestic airfares, accommodation, and all tuition fees to bring them from their nations to study and be trained at Bethel Bible College, and at a later stage, the World Missions Faith Training School.

Students come for a period of two years. They have the option of a third year of practical field ministry exposure, working alongside Bethel pastors and staff or in one of our other CRC churches in a different province within PNG. Most students return back to their home nation and either

work in CRC ministries or in their own denominations from which they originally came from. Some selected graduates stay for a fourth year and became part of the Bethel Christian Centre staff, working in various ministry departments.

Our earliest students came some time before 1987. From 1987 onwards a good number of students began coming to PNG under ISSP. Since the program began until now, we have seen students come from India, the Philippines, Fiji, Indonesia, the Solomon Islands, Sri Lanka, Myanmar, Ghana, Tonga, Vanuatu, Australia and New Zealand.

Some of our previous students have become missionaries in other countries outside of their own nations.

In 2019 we have one young lady from Ghana and another from Vanuatu who are enrolled in our new Preschool Teacher Training Course. They are sponsored by Bethel under ISSP. When they complete their studies they will return to their nations and take up full-time teaching positions in preschools and primary schools.

When we give an opportunity to an individual who would otherwise not have had any hope of training and developing their desire to serve God, we are investing in their lives by empowering them to be the person God designed them to be and to do the things that will benefit His Kingdom.

To give young men and women an opportunity to grow, develop and be inspired to be all that God has for them to do is such a worthy cause. I do not know of any greater reward than investing in the

future of people's lives, and seeing the ongoing investment producing results into the future well beyond ourselves.

To actually see young people become true men and women of God, serving with passion and purpose is such an amazing sight.

Comparing it with our minuscule time and effort given to mentoring, training and growing their lives is truly what I call 'the gold' in life. This is more valuable than position, power, praise and possessions.

People's lives that have been transformed and positioned for God and His kingdom is the real gold in a minister's life. It is a specific joy to have been part of their journey in Christ and that joy continues as we see them walk in partnership with him.

The majority of those trained through ISSP have gone on to Christian service in their churches and a majority are now pastors and ministers of the Gospel in their own right.

In my view ISSP must continue for many years to come. It is a wonderful way that individuals and churches can significantly invest in the future of someone's life.

I am deeply moved with this thought and theme - 'Sow a seed and change a life'. ISSP is an avenue that sows seeds through the training and mentoring program that it provides.

What an amazing privilege it is to be a partner with God in this kind of program.

Blessings,
Pr Barry Silverback



HUGHES FAMILY UPDATE

Greetings to you all from Walhalla, South Carolina in the United States of America (USA) where we have been enjoying beautiful summer weather.

We pray that you are all well strengthened every day in the power of His (God the Father's) might.

In the month of June we continued to have new people turning up for our services. We recently we had one lady turn up who did some training at Faith Center in the past.

One of our greatest needs is for new people to come and make a commitment to regularly attend our services. It is mine, Omega's and the family of God's desire

here for the church family to grow.

We continue to have our men's fellowship meeting on Saturday mornings once a month, and the ladies all meet on a Thursday once a month.

We have sister Jamie Jackson and Omega leading us in worship now. We have been singing some of the good old songs, even without the piano sometimes, and it has been good. I have heard some of our congregation members singing more than they have done in the past.

We celebrated Father's Day here on Sunday 16th June. We had a great celebration.

We had a pastor from Durban in South Africa come to visit us with his wife and they ministered in the church. They are from Canaan ministries in South Africa and

come to the USA every year.

We enjoyed the ministry of the word that Pr Gonsil and Dawn Chetty gave and the encouraging word to the church family that Faith Christian Center will grow. We had several different people come along for our service the day Pr Gonsil ministered

We went out to a block of apartments this month knocking on doors asking people if they needed us to pray for them. We got a good response from those that opened their doors. One lady told us that she had just been told that she has breast cancer and she really needed prayer. We prayed for her and encouraged her.

God's timing is perfect and I was really encouraged by our decision to go to this specific apartment block, rather than the other apartments we could have gone to. It was definitely the leading of Jesus.

There were six of us that went door knocking. The other team prayed for some others that also had cancer. We also prayed for a lady that had been bitten by a spider and was on antibiotics.

Another lady said she has been sick for 16 years so we prayed for her. She was amazed that we turned up at her door as she had been praying to God for some help. We prayed for her and Omega and I went back another day as promised to check on her. She told us she was feeling much better.

We are basically aiming to build a bridge with the community to show them that we do care for them.

During our teaching nights on Wednesdays

we had been studying the gifts and character. We have now finished this study. It was really encouraging to see people's faces when they realised they had been operating in a particular gift. It was also great to see how some of what we were looking at in character was relevant to them specifically.

We will move into some study on prayer and fasting as we head into July. We will begin with an hour of prayer and fasting on a Sunday night for a start and see how we go.

All of our family are well and we are enjoying being here at Faith Center Church. Omega is beautifying the gardens around the house and has been out several times this month enjoying fellowship with the ladies.

I recently gave the boys a project which involved sanding and varnishing the top of our dining room table. It is looking very good now. This was part of my work skills program for the boys.

I have also had them help me do some trimming back of some shrubs that were getting a little overgrown. In addition to this, the boys are helping mow the church property, as well as watering and looking after the vegetable gardens.

This month we have had a little bit of a look around up in the mountains. They are very lush and green now.

We appreciate all of your prayers and ongoing support for us as a family. Thank you all.

Pr Warwick Hughes

JULY CALENDAR

	SUNDAY	MONDAY	TUESDAY	WEDNESDAY	THURSDAY	FRIDAY	SATURDAY
		1 Office Closed	2 5:30pm Conversational English Course 7:00pm Empower and Engage Connect	3 10:00am Giggle Patch Playgroup	4	5 6:00pm Empower Youth	6
	7 8:30am Music Practice 9:30am Prayer Meeting 10:00am Morning Service	8 Office Closed	9	10	11	12	13
	14 8:30am Music Practice 9:30am Prayer Meeting 10:00am Morning Service	15 Office Closed	16	17	18 10:00am Seniors Event	19	20
	21 8:30am Music Practice 9:30am Prayer Meeting 10:00am Morning Service	22 Office Closed	23 5:30pm Conversational English Course 5:30pm Finance Team Meeting 7:00pm Empower and Engage Connect	24 10:00am Giggle Patch Playgroup	25 5:30pm Elders Board Meeting	26 6:30pm Empower Youth	27
	28 8:30am Music Practice 9:30am Prayer Meeting 10:00am Morning Service 11:45am Annual General Meeting	29 Office Closed	30 5:30pm Conversational English Course 7:00pm Empower and Engage Connect	31 10:00am Giggle Patch Playgroup			



Upcoming events

Missions Sunday

Sunday 7th
July

10:00am

Vision Sunday

Sunday 28th
July

10:00am

Annual General Meeting

Sunday 28th
July

11:45am

Prayer and Praise Night

Thursday 8th
August

7:30pm